

WrapShield RS Rain Screen is a highly vapor permeable Water Resistive Barrier (WRB) and Air Barrier (AB) membrane with a built-in rain screen drainage matrix and integrated tape at the horizontal seams.

- Create rain screen cavity with one step installation
- Easily maintain vertical drainage plane
- Replaces furring strips and battens
- Works with all types of cladding and stucco systems

Built-in Rain Screen Drainage Matrix

- High performance matrix maintains unimpeded vertical drainage plane
- Rain screen cavity increases drying capacity of building envelope
- Multiple depth drainage matrix options: 3mm, 7mm, 11mm
- 3mm matrix creates minimal rain screen cavity, facilitating conventional installation of siding, trim, and windows
- 7mm and 11mm matrices offer enhanced drainage performance for code and/or more demanding applications

Cost and Labor Savings

- One step installation of WRB and rain screen cavity reduces installation time
- Innovative integrated tape and horizontal lap guides ensures proper shingle installation
- Factory installed integrated tape and fully-tested accessories reduce contractor liability and take the guesswork out of product selection
- Single source savings eliminates purchase of additional tapes or rain screen components
- Can be used as part of an air barrier system reducing energy use for the life of the building

Phase Construction Friendly

- Install year round in all climates, no construction setbacks
- No special equipment required
- Sustains up to 180 days of exposure before cladding installation

Environmental Sustainability and Durability

- Emits Zero VOC's, no exposure to harmful chemicals
- Contributes to LEED points
- Contributes to the lifelong health and energy efficiency of the build
- Guaranteed long-term durability with standard 20 year material warranty

WRAPSHIELD RS™ RAIN SCREEN

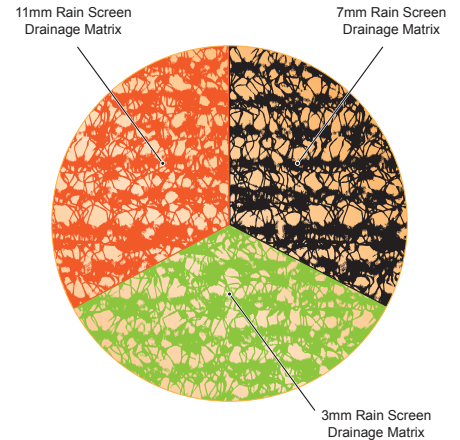

Three rain screen drainage matrix choices offer cost saving options

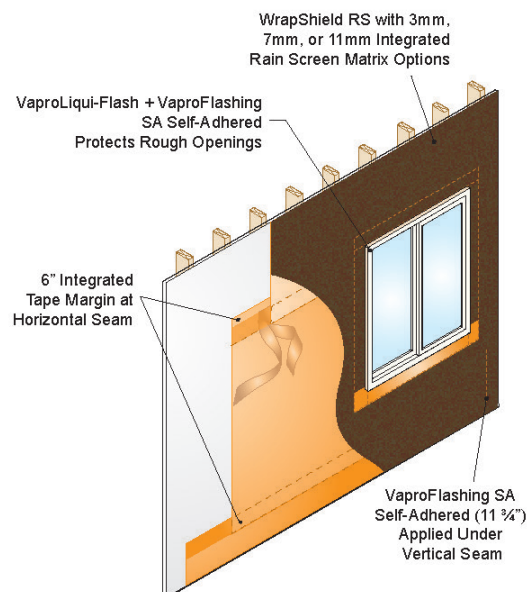
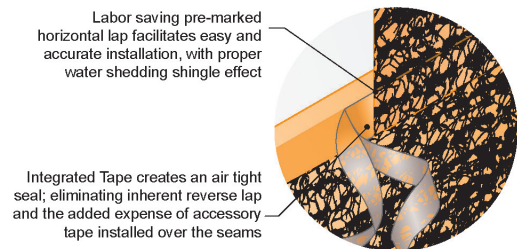

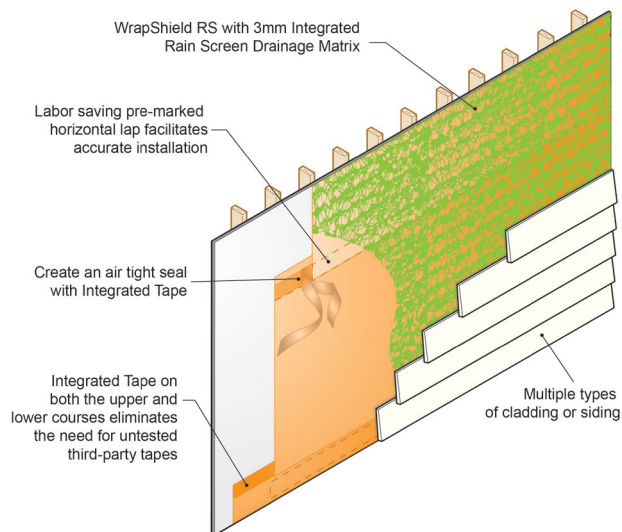
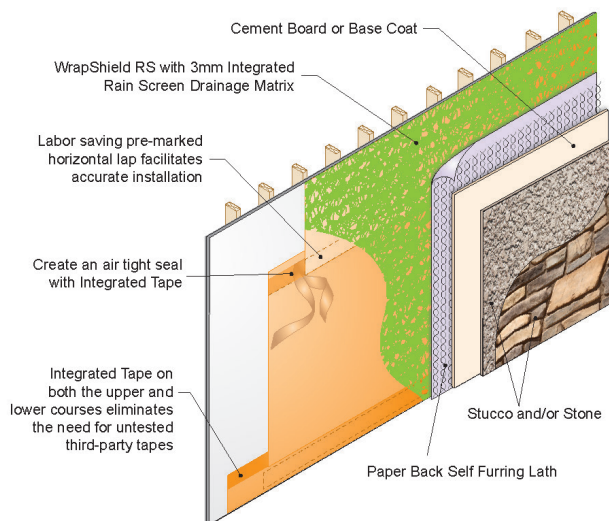

NEW! WrapShield RS with 3mm Rain Screen Matrix

Tested in accordance with ICC-ES AC 308 criteria to meet IBC and IRC requirements for Water Resistive Barriers.

PROPERTY	STANDARD/TEST	RESULT
AIR BARRIER TESTING		
Air Permeance of Building Materials	ASTM 2178 (required for Massachusetts Energy Code and Air Barrier Association of America criteria)	0.0095 L/s/m ² 0.0019 cfm/ft ² PASS
Air Leakage through Wall Systems	ASTM E-283	0.00017 L/s/m ² 0.000034 cfm/ft ² PASS
Air Retarder Materials & Systems	ASTM E-1677	Type 1 Air Barrier PASS
Dry Breaking Force	ASTM D5034	MD - 44.8 lbf/inch (7.8 N/mm) CD - 25.1 lbf/inch PASS
Water Resistance (control and weathered specimens)	AATCC 127 (55cm hydrostatic head of water for 5 hrs)	No leakage noted on underside of control or weathered samples. PASS
Water Vapor Transmission	ASTM E96* (Method B)	308.9 g/m ² 24hrs 2860 ng/Pa/s/m ² 50 Perms PASS
Flamespread Index	ASTM E-84	Class A PASS
Smoke Development Index	ASTM E-84	Class A PASS

*ASTM E 96 - Method B (wet cup method) typically gives a more realistic result for permeance for highly permeable products than does the Method A (dry cup/desiccant method).



Factory installed integrated tape seals in all weather conditions and eliminates water concerns at horizontal joints.

Visit VaproShield.com for:



Comprehensive Testing Data



Installation Instructions



Details